

# Monomando de Lavabo Deco sin Contra / Deco Single Handle Lavatory without Drain

MO8-DC01-6

PORTAFOLIO VERDE CSI. 22 42 39

NC

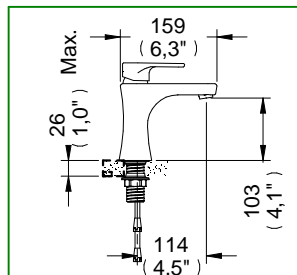
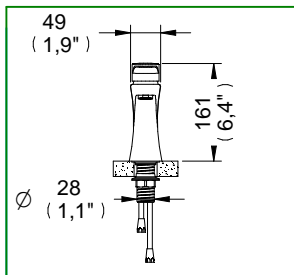

Medidas Referenciales / Estimated Dimensions, Acot.mm.(pulg) / Dim.mm.(in)

## Características y Datos Técnicos / Characteristics and Technical Details

Cartucho Cerámico para Monomando

Ceramic Cartridge

**Material:**  
Latón

**Material:**  
Brass

**Conexión:**  
½" -14 NPSM

**Inlet thread:**  
½" -14 NPSM

**Presión de Trabajo:**  
Pmin= 0,5 kg/cm<sup>2</sup>  
Pmax= 6,0 kg/cm<sup>2</sup>

**Working Pressure:**  
Pmin= 7,11 PSI  
Pmax= 85,34 PSI

## Despiece / Components

Mod.	Descripción	Mod.	Description
1	Pr2-2670 Opresor Allen 8-32 UNC x 1 1/16" Long	1	Pr2-2670 Oppressor Allen 8-32 UNC x 1 1/16 "Long.
2	Pr2-612 Chapetón 1-1/8"	2	Pr2-612 1-1/8" Escutcheon
3	Pr2-613 Tuerca 1-½" 24 UNS-2A	3	Pr2-613 1-½" 24 UNS-2A Nut
4	Ps2-1221 Cartucho Monomando c/ Barreno Pasado	4	Ps2-1221 Cartridge mixer w / Hole Past
5	Ps2-1172 Inserto Cartucho de 35mm Soldado	5	Ps2-1172 35 mm Insert Cartridge
6	Pr2-2202 Empaq. p/ Monom. con Inserto	6	Pr2-2202 Gasket with Insert
7	Pr3-1063 Tornillo Autorroscante 8-32	7	Pr3-1063 8-32 Self-tapping Screw
8	Pr5-1283 O'ring 2-222	8	Pr5-1283 2-222 O'Ring
9	Pr2-1459 Espárrago Grande	9	Pr2-1459 Spout Stud
10	Pr2-1473 Separador Cuerpo Central	10	Pr2-1473 Central Body Spreader
11	Pr2-1472 Rondana Acero Inox.	11	Pr2-1472 Stainless Steel Washer
12	Pr2-1471 Tuerca Espárrago	12	Pr2-1471 Spout Stud Nut
13	Pr2-253 O'ring 2-011	13	Pr2-253 O'ring 2-011
14	Pr2-1653 Tuerca Conector Alimentador	14	Pr2-1653 Feeding Coupling Nut
15	Ps8-1020 Aireador pca perlator a 5.67 lts/min	15	Ps8-1020 Aerator pca perlator 5.67 lit/min
16	Pr5-431 Llave Allen 5/64"	16	Pr5-431 5/64" Allen Wrench
	Sub- ensamble		Sub- assembly
17	Ps2-1839	17	Ps2-1839
18	Ps2-1247	18	Ps2-1247

\* Los productos ilustrados pueden sufrir cambios sin previo aviso en su aspecto o partes, como resultado de los procesos de mejora continua al que están sujetos, sin implicar mayor responsabilidad de la fábrica.

\* Products depicted here in subject to change without prior notice in their appearance or components as a result of incremental innovation.

